



Precision Spindle Collet Chuck

JAM-42D Spindle Collet Chuck

Gripping Length from 110mm to 185mm



- ▶ Double-collets spindle collet chuck.
- ▶ Chuck basic grip length: 110mm.
- ▶ Optional extended taper sleeve: 50mm or 75mm.
- ▶ Spindle chuck grip length: 110mm/160mm/185mm.
- ▶ Chucking run-out: 0.030mm.
- ▶ Max. operating speed: 2000RPM.
- ▶ Compact chuck size: easy for parts auto-loading.
- ▶ Compressed air actuated.



JAM-42D Dimension/Specification

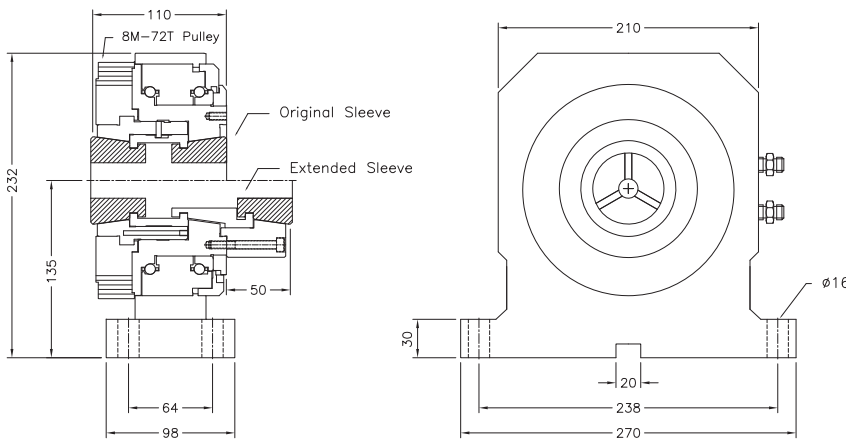

Model	JAM-42D Spindle Chuck
Working Collet	JR-42A Collet x 2pcs
Air Pressure	3-8kg/cm ²
Grip Range	6mm-42mm
Basic Grip Length	110mm
Extended Sleeve	50mm/75mm (optional)
Max. Grip Length	185mm
Chucking Run-out	0.030mm
Max. RPM	2000RPM
Weight	26.0kgs (57.2lbs)

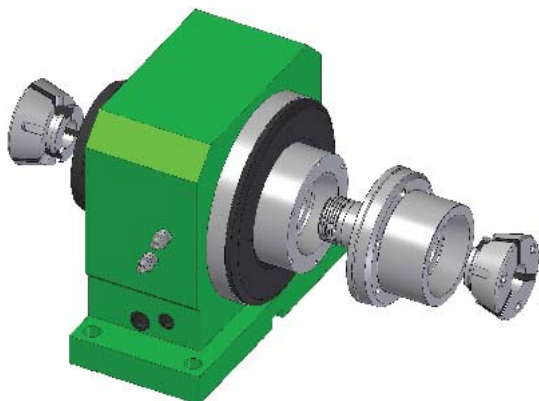

JAM-42D Chuck with Extended Taper Sleeve:
Grip Length from 110mm to 185mm

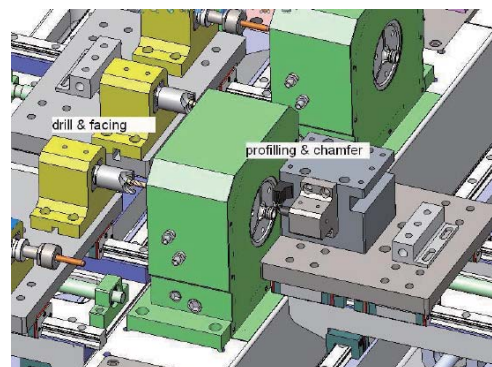

A SPM (Special Purpose Machine) is designed for processing motor-bike parts. Chamfering/ Grooving/Centering/Drilling on both side of the work-part will be done at one loading.